

WINGCO[®] GENERATORS



An American Company

We produce our products in our 200,000ft² facility located in Le Center, Minnesota, equipped with modern engineering, fabrication and assembly capabilities.



Full Load Tested

Every generator is 100% load tested



DSE 7310 Controller

Provides immediate performance information



Coolant Heater

120V in-line Hotstart coolant heater with thermostat



Battery Charger

5 Amp, smart marine charger standard



TÜV Certified

The design, construction, and performance of our stationary generators conform to UL2200 & CSA standards



DR2014

20,000 WATTS

Rugged Design
Galvanized steel enclosure with powder coat paint



Industrial Isuzu Engine

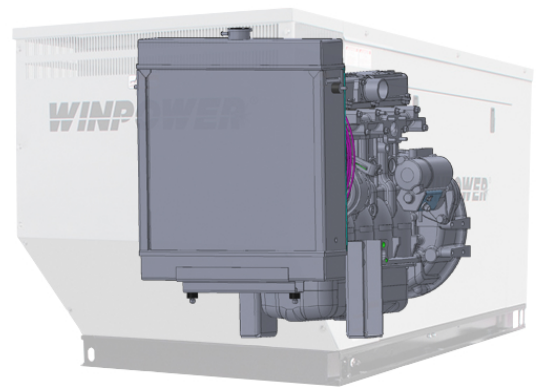

Brushless Industrial Genend
Auxiliary Windings Standard



SPECIFICATIONS

ELECTRICAL

VOLTS	POWER FACTOR	STANDBY			PRIME			CIRCUIT BREAKER
		WATTS	KVA	AMPS	WATTS	KVA	AMPS	
120/240 1-PH	1.0	20,000	20	83	18,000	18	75	90
120/208 3-PH	0.8	20,000	25	69	18,000	22.5	62	70
120/240 3-PH	0.8	20,000	25	60	18,000	22.5	54	70
277/480 3-PH	0.8	20,000	25	30	18,000	22.5	27	30
346/600 3-PH	0.8	20,000	25	24	18,000	22.5	21	30

ENGINE

ENGINE MANUFACTURER	ISUZU
ENGINE MODEL	4LE2
TIER	IV
ENGINE STARTER	12V ELECTRIC
ENGINE SPEED	1800 RPM
ENGINE CYLINDERS	4
HP RATING	33
FREQUENCY	60 HZ
ALTERNATOR	20 AMPS
FLYWHEEL	10"
ROTATION	CCW
ASPIRATION	NATURAL
COOLANT	2.8 L
BORE/STROKE	85 mm x 96 mm
DISPLACEMENT	2.2 L
RECOMMENDED OIL ⁽²⁾	5W-30 SAE
OIL CAPACITY	8.6 QT
INJECTION PUMP	BOSCH PFR TYPE
GOVERNOR	MECHANICAL
COMPRESSION RATIO	21.5:1
FAN TYPE	PUSHER
COMBUSTION AIR	60.2 CFM
RADIATOR COOLING AIR	3875 CFM
EXHAUST FLOW	--
EXHAUST OUTLET SIZE	2"
STARTING AIDS	GLOW PLUGS
STARTING TEMP NATURAL W/ AIDES	5°F
STARTING TEMP W/ BLOCK HEATER	-15°F

NOTES: (1) Muffler ships loose. (2) The recommended oil is for normal applications. See operator's manual for the recommended oil for your needs.

DBA @ 7 METERS

FULL LOAD	73
-----------	----

DR20

MOTOR STARTING (CODE G)	7 HP
TOTAL HARMONIC DISTORTION	< 5%
FLOATING NEUTRAL	YES
FORK LIFT POCKETS	NO
ASSEMBLED IN	USA
EPA APPROVED TIER	TIER IV INTERIM (STANDBY)
CARB APPROVED	TIER IV INTERIM (STANDBY)
TÜV CERTIFICATION	UL2200 CSA

UNIT WARRANTY ⁽¹⁾	
STANDBY	2 YEAR/2000 HRS

NOTES: (1) For more generator warranty, see operator's manual.

GENERATOR END

WINDING	
SINGLE PHASE	4 LEAD
THREE PHASE	12 LEAD
WINDING NUMBER	
SINGLE PHASE	06
THREE PHASE	311
VOLTAGE REGULATION	AVR +/- 1%
AVR TYPE	AS540
TEMPERATURE RISE	125/40° C
BRUSHLESS	YES
SPEED	1800 RPM
ROTOR	2/3 PITCH
WINDINGS	100% COPPER
STATOR WINDING	
SINGLE PHASE	SINGLE LAYER CONCENTRIC
THREE PHASE	DOUBLE LAYER CONCENTRIC
COUPLING	DIRECT/FLEXIBLE DISC
BEARINGS	SINGLE (MAINTENANCE FREE)
EFFICIENCY PEAK	
SINGLE PHASE 1.0 PF	82.9
THREE PHASE 0.8 PF	84.1
INSULATION	CLASS H
INGRESS PROTECTION	IP23



SPECIFICATIONS

BLOCK HEATER

VOLTS	120
WATTS	1,000
AMPS	8.4
THERMOSTAT	
ON	100° F
OFF	120° F

DERATES

ABOVE SEA LEVEL	3% PER 1000 FT
TEMPERATURE >104°F	3% PER 10°F

FUEL

TYPE	ASTM D975 NO-2D DIESEL
FUEL CONSUMPTION	GAL/HR
100%	1.80
75%	1.44
50%	1.11
25%	0.78
OPTIONAL FUEL TANK	L x W x H
54 GAL COMPOSITE	63" x 34" x 10"
55 GAL UL142	63" x 34" x 13"
110 GAL UL142	63" x 34" x 23"
155 GAL UL142	63" x 34" x 33"

NOTES: (1) Tanks are double-walled, UL142 listed, except for the 54 gallon composite tank.

DSE 7310 CONTROLLER

ENGINE DISPLAY/PROTECTION

ENGINE RPM	YES
LOW OIL PRESSURE	YES
HIGH COOLANT TEMP	YES
LOW COOLANT	YES
OVER/UNDER SPEED	YES
OVER CRANK	YES
CAN ECU SHUTDOWN	YES

GENSET DISPLAY/PROTECTION

VOLTAGE (L-N & L-L)	YES
OVER/UNDER VOLTAGE	YES
FREQUENCY	YES
OVER/UNDER FREQUENCY	YES
AMP DISPLAY/SHUTDOWN	YES
PHASE IMBALANCE	FIELD ENABLED
KW, KVA, KVAR DISPLAY	YES
KWH, KVAH, KVARH DISPLAY	YES
GENERATOR PHASE SEQUENCE	OPTIONAL

BATTERY

DC SYSTEM	12V
BATTERY RACK/CABLE	INCLUDED
BATTERY CHARGER	5 AMP
REQUIRED BATTERY ⁽¹⁾	GROUP 24 600 CCA

NOTES: (1) Battery not included.

SHIPPING

SHIPPING DIMENSIONS (L x W x H)	75" x 34" x 45"
SHIP WEIGHT	2,020 LBS
FREIGHT CLASS	70

OPTIONAL ACCESSORIES

BATTERY
BATTERY CHARGER UPGRADE
BATTERY HEATER
MIMIC PANEL
REMOTE MONITORING
FUEL TANK
NFPA COMPLIANT UPGRADE

ADDITIONAL DISPLAYS/PROTECTIONS

EXTERNAL E-STOP	FIELD INSTALLED
BATTERY VOLTAGE	YES
BATTERY OVER/UNDER VOLTAGE	YES

COMMUNICATIONS

USB CONNECTABLE	YES
RS232/RS485	YES
NFPA ANNUNCIATOR	OPTIONAL
REMOTE DISPLAY PANEL	OPTIONAL

ADDITIONAL FEATURES

AUDIBLE ALARM	YES
ENGINE EXERCISER	FIELD ENABLED
MAINTENANCE INTERVAL TIMER	FIELD ENABLED
LOAD SHEDDING/DUMMY	FIELD ENABLED
CONFIGURABLE INPUTS	4 (EXPANDABLE)
CONFIGURABLE OUTPUTS	4 (EXPANDABLE)
EVENT LOG	250

DRAWINGS

OPEN SKID

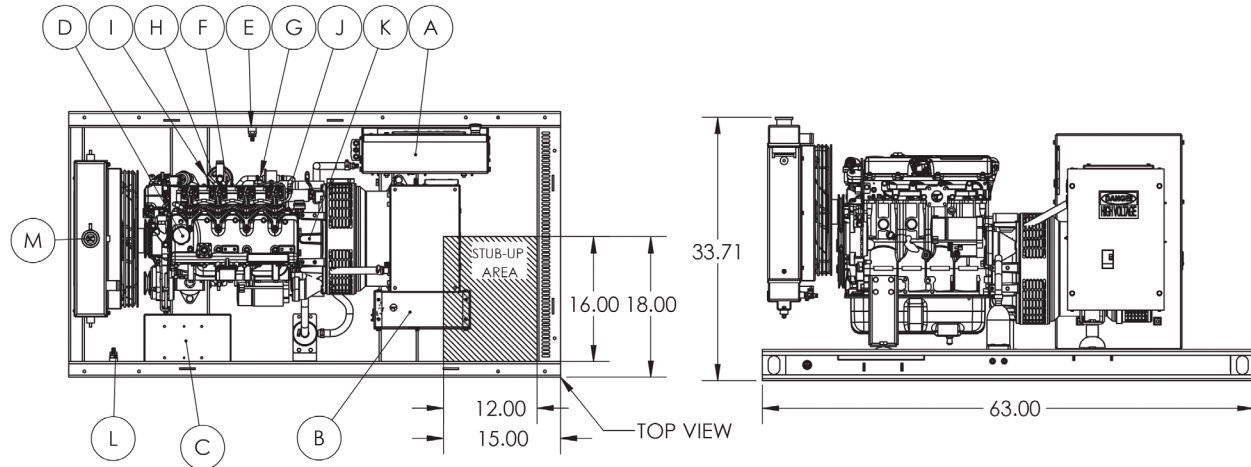

Key Components	
A	ENGINE CONTROL
B	MAIN LINE CIRCUIT BREAKER
C	START BATTERY
D	OIL FILL
E	OIL DRAIN
F	OIL DIPSTICK
G	OIL FILTER
H	FUEL FILTER
I	FUEL IN
J	FUEL RETURN
K	AIR FILTER
L	COOLANT DRAIN
M	COOLANT FILL

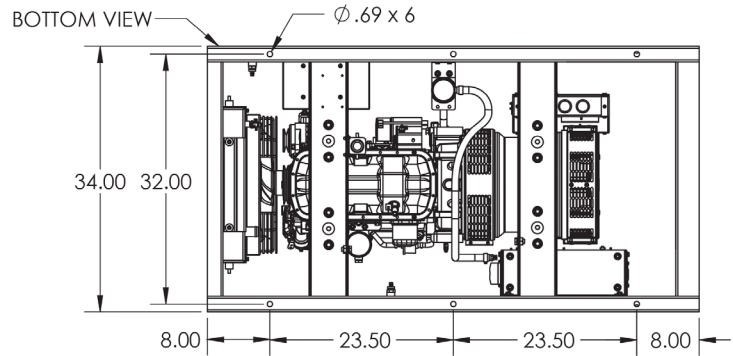

ENCLOSED

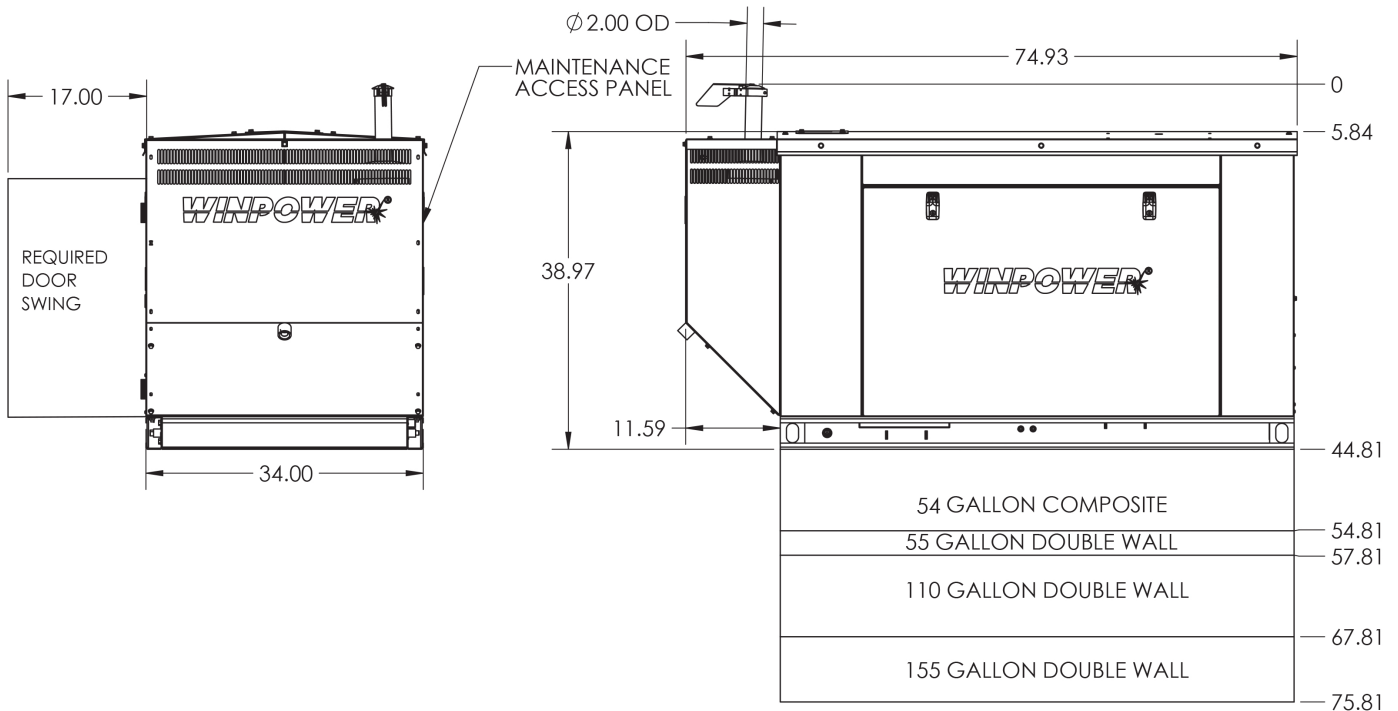

Specifications are subject to change without notice.

